



24 St Peters Close
Ilford, Essex IG2 7QL
£1,700 Per calendar month

24 St Peters Close, Ilford, Essex IG2 7QL

Arbon & Miller are delighted to offer this beautifully presented two-bedroom, second-floor apartment situated within the sought-after St Peters Close, offering stylish, contemporary living in immaculate condition throughout. This exceptional home has been meticulously maintained and boasts a bright and spacious layout, with a well-proportioned reception room ideal for both relaxing and entertaining, alongside a modern kitchen fully equipped with high-quality white goods for added convenience. Two generously sized bedrooms provide comfortable accommodation, complemented by a sleek and well-appointed bathroom. Positioned within a well-kept development, the property enjoys a peaceful residential setting while remaining superbly connected, with a selection of highly regarded local schools nearby and excellent transport links within easy reach, offering swift access into central London and surrounding areas—making this an ideal choice for professionals and small families seeking a premium rental home.



GROUND FLOOR
635 sq.ft. (59.0 sq.m.) approx.

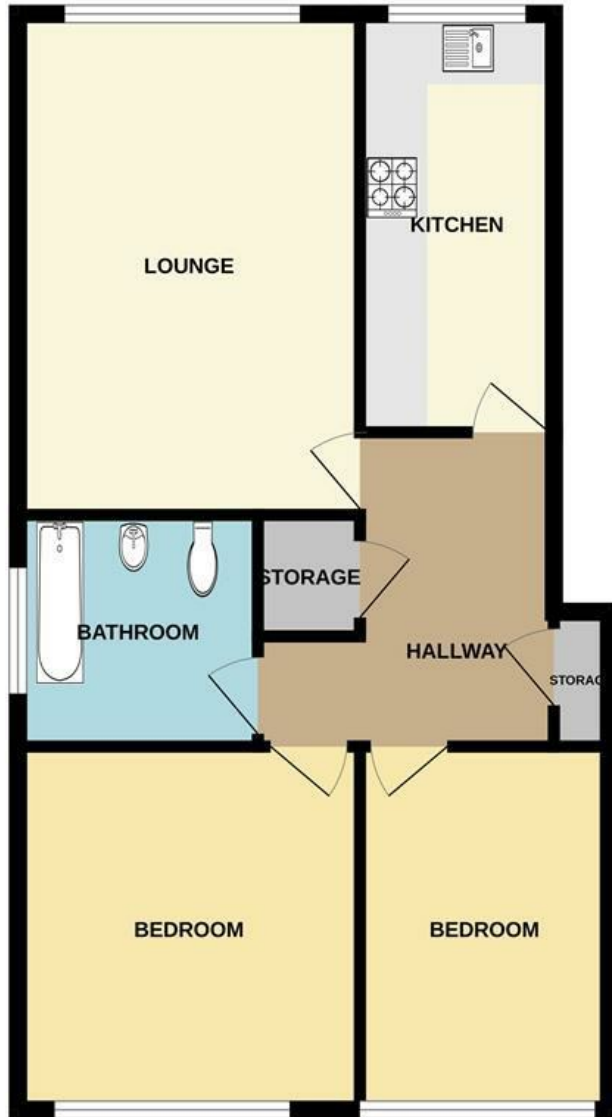

TOTAL FLOOR AREA : 635 sq.ft. (59.0 sq.m.) approx.

Whilst every attempt has been made to ensure the accuracy of the floorplan contained here, measurements of doors, windows, rooms and any other items are approximate and no responsibility is taken for any error, omission or mis-statement. This plan is for illustrative purposes only and should be used as such by any prospective purchaser. The services, systems and appliances shown have not been tested and no guarantee as to their operability or efficiency can be given.
Made with Metropix ©2025

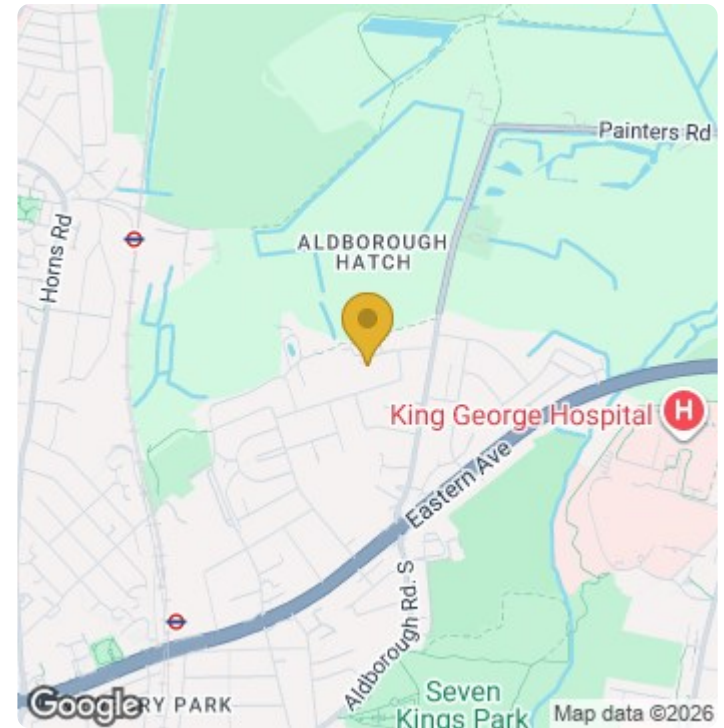

Energy Efficiency Rating

	Current	Potential
<i>Very energy efficient - lower running costs</i>		
(92 plus) A		
(81-91) B		
(69-80) C		
(55-68) D		
(39-54) E		
(21-38) F		
(1-20) G		
<i>Not energy efficient - higher running costs</i>		
England & Wales	EU Directive 2002/91/EC	

